

## Door Sensor IR004(External)

### Functions:

- Automatically switch ON/OFF when the door is open/closed.
- Input Voltage: 12V-24VDC.
- Output Voltage: 12V-24VDC.
- Input Current: 4A.
- 0.5cm≤Detection Range≤10cm.
- Load around 48W for 12V, and 96W for 24V.
- Input and output cable length: DC wire 15cm (customized length can be ordered).
- Dimension: L45\*W31\*H9 mm.



### Operations:

- The LED lamp connects to the output end.
- The IR sensor switch will turn on the LED light when the door is open and will turn off the LED light when the door is closed.
- Detection range is 10cm from the sensor detector to the door.
- The sensor switch will turn on or off the LED light with above repeatable steps.

### Installation Steps:

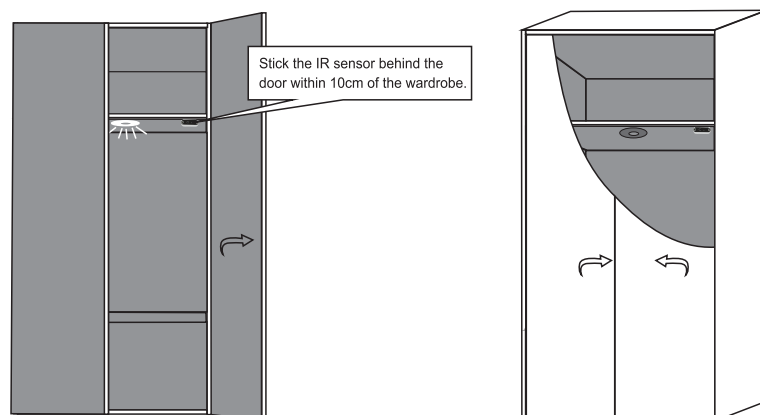

**Note:** Please read the tag on the wire when connecting cables.