

Functions

Model	TD006
Operation	ON/OFF + dimming function +memory
Input Voltage	12V-24V DC
Output Voltage	12V-24V DC
Input Current	4A
Input and output cable length	DC wire 25cm
Load Around	48W for 12V, and 96W for 24V

Connection Diagram

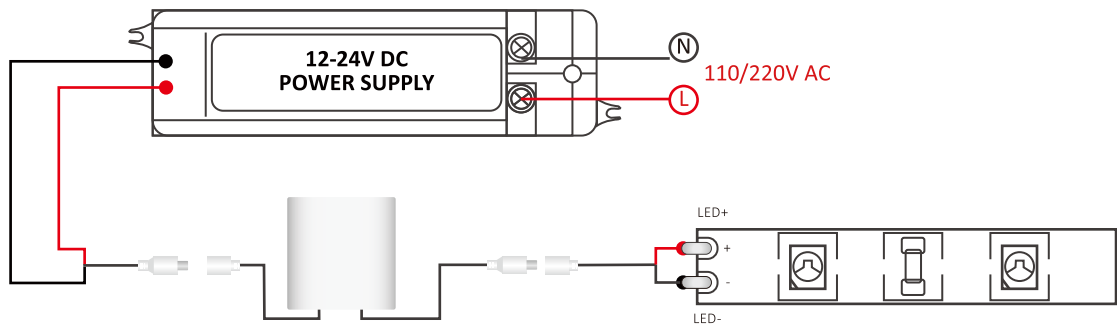

Operations

With memory external switch on/off and dimmer:

Touch the wood panel or glass maximum thickness is 25mm and the minimum thickness is 10mm where the TD006 switch is located to turn ON/OFF the led lamps.

- Originally "Off" when the power is connected.
- Quick touch(time is less than 550ms) can turn ON/OFF the light. One touch to turn on;touch again to turn off.The lamp is 90% bright when it is on.
- Hold on touching (time is above 550ms) can adjust the brightness endlessly. It will reduce the brightness endlessly to the minimum in 3 seconds holding on when the light is on. It will increase the brightness endlessly to 100% in 3 seconds holding on when the light is off.
- Quick touch and hold on touching can be chosen anytime without any collision.
- This sensor will memorize the status of the dimming in 12V-24VDC.

Installation Steps

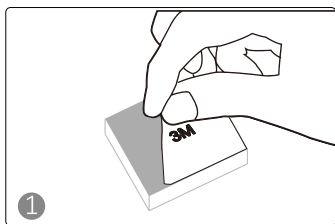

1 Stick the 3M tape on the sensor switch

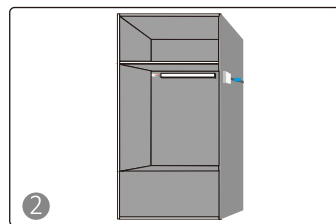

2 Fixed the sensor onto the cabinet

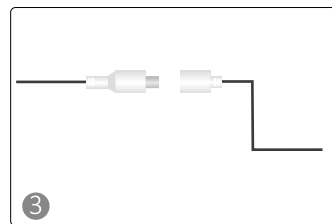

3 Connect to the power supply

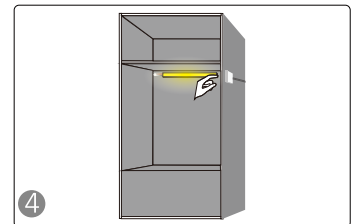

4 Working status

Recommended Profiles/Optional

Model	Color	Size(mm)	Length	Drawing	Photo	Installation
A1707	White	17.4*82	1-3m			Surface mounting
A1715	Black	17.4*15.7	1-3m			Surface mounting
A1920	Aluminum	19.9*18.5	1-3m			Surface mounting

Recommended Strips/Optional

General description

- Available in 12/24V DC maximum
- CRI80 & CRI90 LED Strip are available
- Working temperature: -20°C to +50°C
- Very bright & low power consumption
- Long life span LED lights, more than 50,000 hours
- Adhesive back, peel & stick
- IP20, IP65, IP67 are available

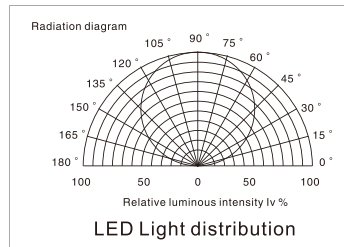

Color Spectrum (CRI90)

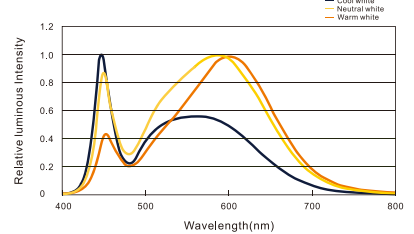

Electronic & Output Data

SMD2835, 60 LEDs/m

Size (mm)	Color	CRI	Photo	LED Qty/m	Lumen/m	Voltage (V)	Power (W/m)	Packing (m/reel)
L5000*W8*H1.5	WW	90+		60	1000	12/24V	14.4	5
	NW				1100			
	CW				1200			

SMD2835, 120 LEDs/m

Size (mm)	Color	CRI	Photo	LED Qty/m	Lumen/m	Voltage (V)	Power (W/m)	Packing (m/reel)
L5000*W10*H1.5	WW	90+		120	1300	12/24V	14.4	5
	NW				1400			
	CW				1500			

SMD2110, 280 LEDs/m

Size (mm)	Color	CRI	Photo	LED Qty/m	Lumen/m	Voltage (V)	Power (W/m)	Packing (m/reel)
L5000*W10*H1.5	WW	90+		280	1420	24V	19.2	5
	NW				1460			
	CW				1510			