

Functions

Model	PS003
Operation	Turn ON/OFF the light when hand pass over the sensor within 18cm
Input Voltage	12V–24V DC
Output Voltage	12V–24V DC
Current	4A max each channel
Detection Range	Detection Range: ≤18cm (When there's no PC cover)
Dimension	55*10mm

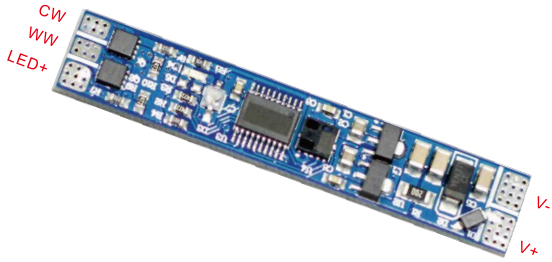

Connection Diagram

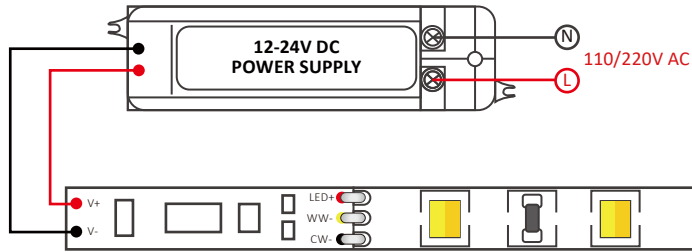

Operations

The Proximity Switch(motion sensor) is designed to be used in LED Aluminum profile. It is dedicated for switching LED lights “on” and “off” without touching the switch. The Proximity switch operates based on an active reflective photocell. The cyclical device sends a string of infrared impulses and measures the strength of the reflected signal. When a hand is close to the sensor the infrared impulses reflect from the hand and bounce back to the sensor. If the strength of the signal is maintained on the appropriate level, the output of the sensor will reverse its state. The infrared light is emitted on a definite frequency as a result. The sensor is resistant to signals coming from other sources such as infrared remote controls, lamps or sunlight.

*Caution: avoid being exposed to the other lamp or strong light outside the lamp.

Function

- Turn ON/OFF the light when hand pass over the sensor within 18cm
- Hold the hand over the sensor switch within 18cm more than 1 second, adjusting the double color led light brightness of one led color from 0% to 100% and of another led color from 100% to 0%; only the led color temperature is adjustable, the blue led on the switch is flashing at the same time.
- With 0V memory function.

Installation Steps

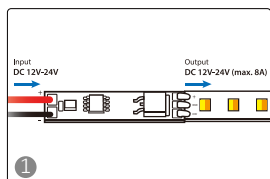

Connect wires to the input end and connect LED strip to the output end

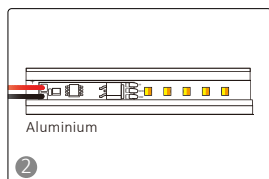

Install the sensor into the aluminum with double sided adhesive tape

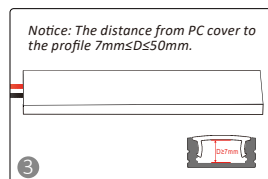

Click the PC cover to the aluminum

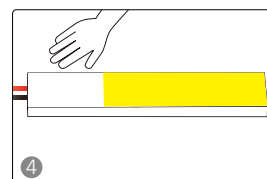

Working Status

*Notice: The distance from PC cover to the profile $7\text{mm} \leq D \leq 50\text{mm}$

Recommended Profiles/Optional

Model	Color	Size(mm)	Length	Drawing	Photo	Installation
A1707	White	17.4*82	1-3m			Surface mounting
A2507	Black	23.7*8.2	1-3m			Recessed mounting

Recommended Strips/Optional

General description

- Available in 12/24V DC maximum
- CRI80 & CRI90 LED Strip are available
- Working temperature: -20°C to +50°C
- Very bright & low power consumption
- Long life span LED lights, more than 50,000 hours
- Adhesive back, peel & stick
- IP20, IP65, IP67 are available

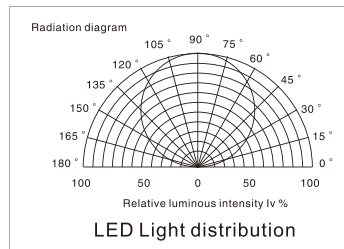

Color Spectrum (CRI90)

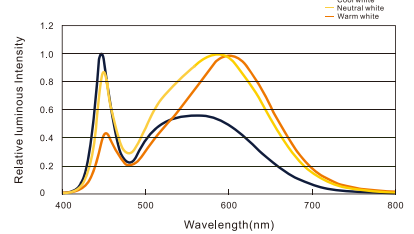

Electronic & Output Data

SMD3527, 120 LEDs/m

Size (mm)	Color	CRI	Photo	LED Qty/m	Lumen/m	Voltage (V)	Power (W/m)	Packing (m/reel)
L5000*W10*H2	WW+CW	80+		120	840+960	12/24V	19.2	5

SMD5025, 60 LEDs/m

Size (mm)	Color	CRI	Photo	LED Qty/m	Lumen/m	Voltage (V)	Power (W/m)	Packing (m/reel)
L5000*W10*H2	WW+CW	80+		60	720+810	12/24V	14.4	5