

Power Track System

Surface mounting

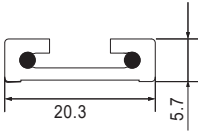
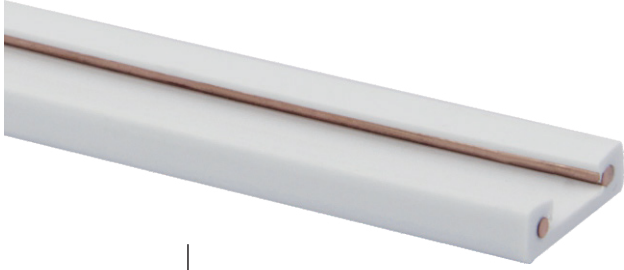

Model: TRACK01

Track: 25Amax. 12VDC/24VDC

Recessed mounting

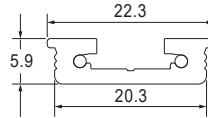

Model: RTR01

Track: 25Amax. 12VDC/24VDC

Accessory:



Model: TRACK02N

Connector: 8A max with VDE#18 cable;
4A max with AWG#22 cable

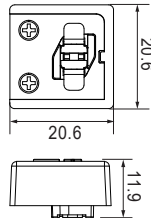

Model: TRACK03

Power input Connector
With 2meter VDE#18 cable;
Max Load: 8A

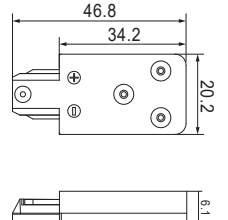

Model: TRACK06

Connector: 8A max with VDE#18 cable;
4A max with AWG#22 cable

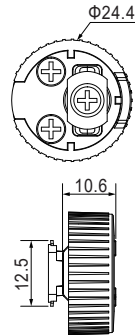

Model: TRACK04

End cap of power track

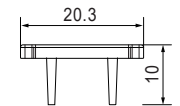

Model: ZTR02

Connector: 4A max with AWG#22 cable

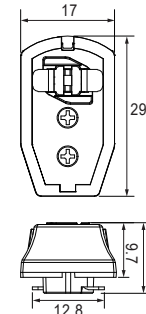

Model: TRACK05

Middle track connector between 2 tracks

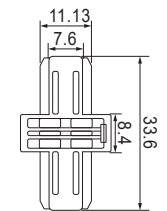

LCM01

Line clamping magnet

18-24AWG, 2468 parallel lane

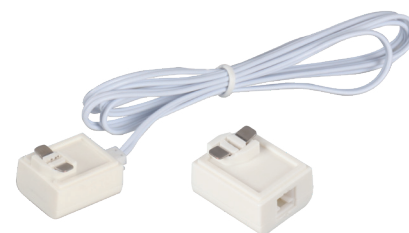

Model: ZTR06

Connector: 4A max with AWG#22 cable

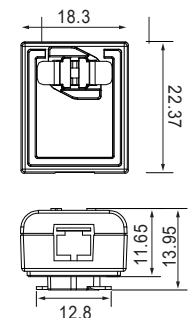

Notice: Black color power track and black accessories are also available.

Power Track System

Connection Diagram:

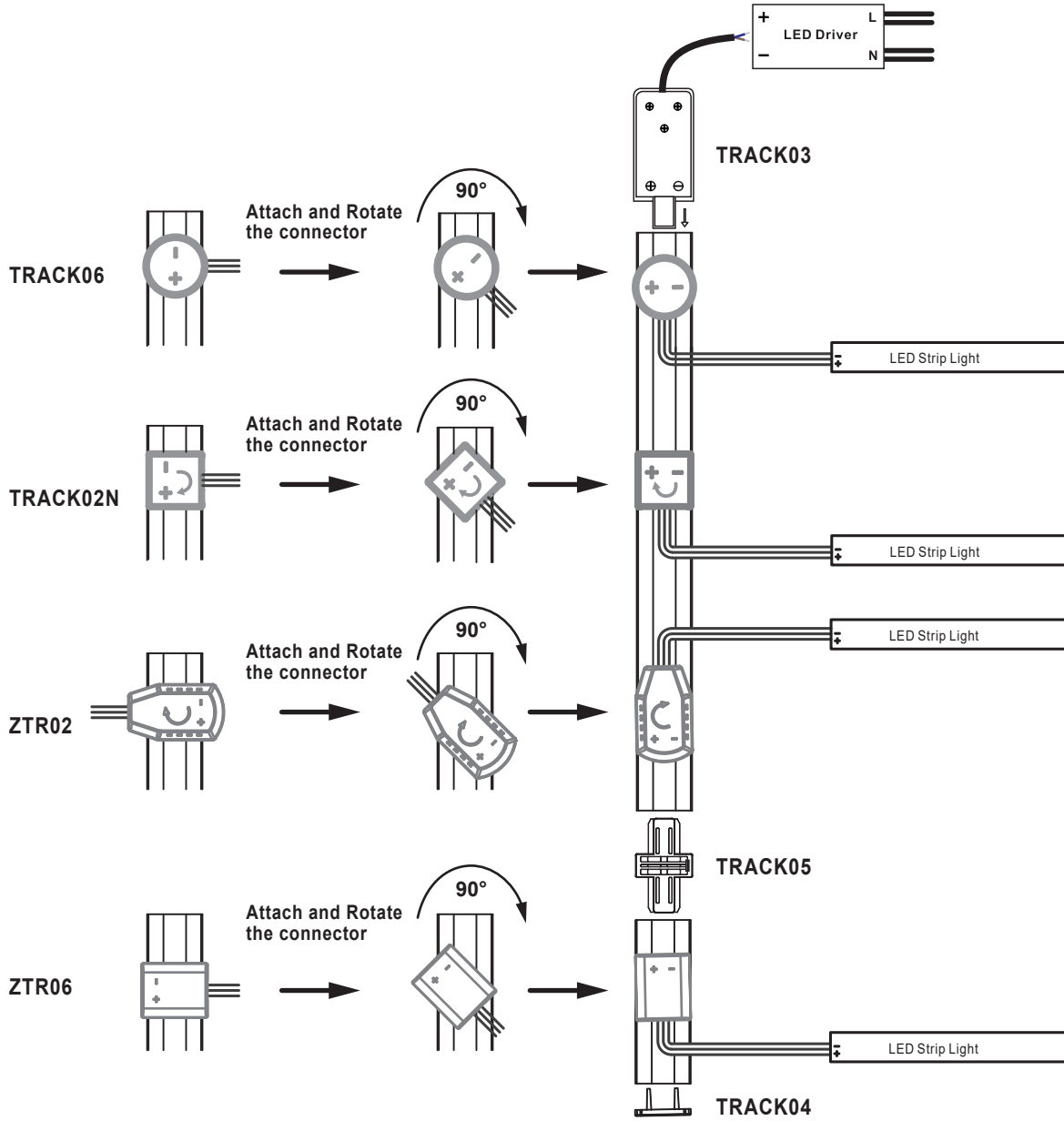

Application:

